

DATE	REVISION
8-10-18	RESUBMIT PLAN
8-24-18	MODIFY CURB RAMP
10-19-18	UPDATE STARBUCKS C & D
	UPDATE STARBUCKS DETAILS

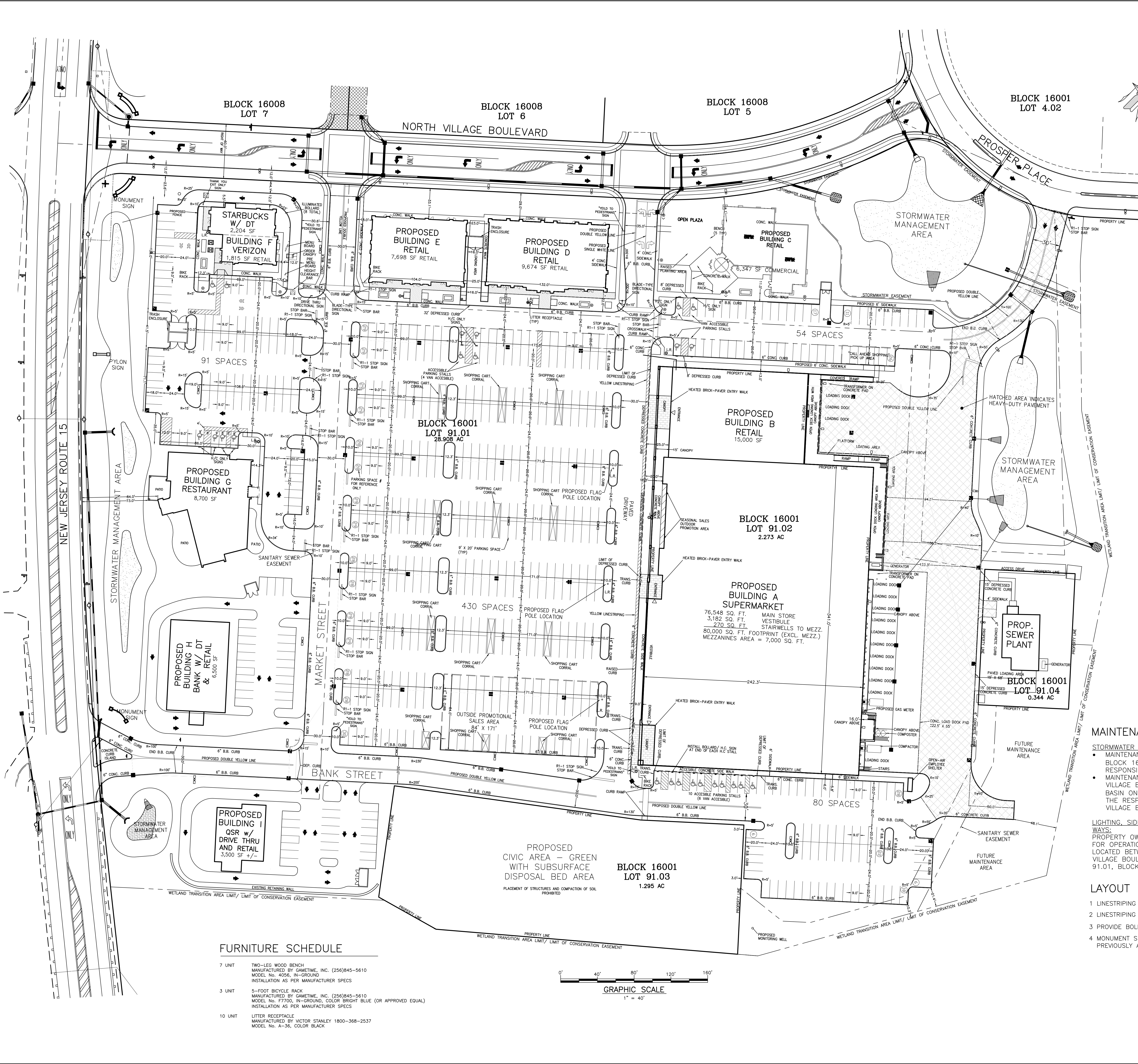

PARKING CALCULATIONS

BUILDING No.	BUILDING AREA	PARKING REQUIRED (1 SPACE PER 300 SF)	PARKING REQUIRED (1 SPACE PER 3 SEATS)	TOTAL REQUIRED	TOTAL PROVIDED
BUILDING A	80,000	290*			
BUILDING B	15,000	50			
BUILDING C	6,347	22			
BUILDING D	9,674	33			
BUILDING E	7,698	26			
BUILDING F(1)	1,800	9			
BUILDING F(2)	60 SEATS		20		
BUILDING G	250 SEATS		84		
TOTAL		430	104	534	657

* INCLUDES 7,000 SF MEZZANINE

ACCESSIBLE PARKING CALCULATIONS

BUILDING No.	PARKING REQUIRED	ACCESSIBLE PARKING REQUIRED	ACCESSIBLE PARKING PROVIDED	VAN ACCESSIBLE PARKING REQUIRED	VAN ACCESSIBLE PARKING PROVIDED
BUILDING A	290	7	10	2	6
BUILDING B	50	2	2	1	2
BUILDING C	22	1	2	1	2
BUILDING D	33	2	3	1	2
BUILDING E	26	2	3	1	2
BUILDING F	29	2	3	1	2
BUILDING G	84	4	4	1	2
OVERFLOW	123				
TOTAL	534	20	27	8	18

LEGEND:

- STORMWATER CATCHBASIN
- ▨ HEAVY DUTY PAVEMENT AREA
- ⊙ PARKING LOT LIGHTS
- ⊙ DECORATIVE LIGHT POSTS
- ⊙ BUILDING/CANOPY MOUNTED LIGHTS
- FLAG POLE LIGHTS
- BOLLARD

MAINTENANCE RESPONSIBILITY NOTES:

- STORMWATER MANAGEMENT FACILITIES:**
- MAINTENANCE OF STORMWATER MANAGEMENT BASINS ON TAX LOT 91.01, BLOCK 16001 (INFILTRATION BASINS A1, A2, B3 AND B4) SHALL BE THE RESPONSIBILITY OF PROPERTY OWNER OF TAX LOT 91.01, BLOCK 16001.
 - MAINTENANCE OF DRAINAGE STRUCTURES AND STORMSEWER FROM NORTH VILLAGE BOULEVARD AND PROSPER PLACE TO STORMWATER MANAGEMENT BASIN ON TAX LOT 91.01, BLOCK 16001 (INFILTRATION BASIN B3) SHALL BE THE RESPONSIBILITY OF SPARTA TOWNSHIP UPON ACCEPTANCE OF NORTH VILLAGE BOULEVARD & PROSPER PLACE AS A MUNICIPAL STREET.

LIGHTING, SIDEWALK AND LANDSCAPE MAINTENANCE WITHIN MUNICIPAL RIGHT OF WAYS:
 PROPERTY OWNER OF TAX LOT 91.01, BLOCK 16001 SHALL BE RESPONSIBLE FOR OPERATION & MAINTENANCE OF LIGHTING, SIDEWALKS AND LANDSCAPING LOCATED BETWEEN THE CURB LINE AND THE RIGHT OF WAY LINE OF NORTH VILLAGE BOULEVARD & PROSPER PLACE ALONG THE FRONTAGE OF TAX LOT 91.01, BLOCK 16001.

LAYOUT PLAN NOTES

- LINESTRIPING IN PARKING AREAS TO BE COLOR WHITE UNLESS OTHERWISE NOTED.
- LINESTRIPING FOR HANDICAPPED PARKING AREAS & SYMBOLS TO BE COLOR BLUE.
- PROVIDE BOLLARDS AS SHOWN ON UTILITY DETAIL PLANS.
- MONUMENT SIGNS AT ENTRANCES AND PYLON SIGN AT ROUTE 15 HAVE BEEN PREVIOUSLY APPROVED BY THE SPARTA TOWNSHIP PLANNING BOARD.

FURNITURE SCHEDULE

- 7 UNIT TWO-LEG WOOD BENCH
 MANUFACTURED BY GAMETIME, INC. (256)845-5610
 MODEL No. 4056, IN-GROUND
 INSTALLATION AS PER MANUFACTURER SPECS
- 3 UNIT 5-FOOT BICYCLE RACK
 MANUFACTURED BY GAMETIME, INC. (256)845-5610
 MODEL No. 7770, IN-GROUND, COLOR BRIGHT BLUE (OR APPROVED EQUAL)
 INSTALLATION AS PER MANUFACTURER SPECS
- 10 UNIT LITTER RECEPTACLE
 MANUFACTURED BY VICTOR STANLEY 1800-368-2537
 MODEL No. A-36, COLOR BLACK

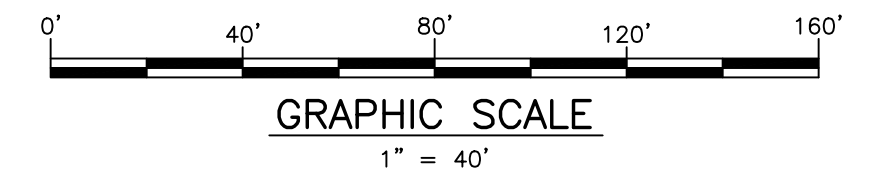

DYKSTRA ASSOCIATES

DOUWE DYKSTRA

PROJECT NO.: SP-64
 CONTOUR INT.: N/A
 SCALE: 1" = 40'
 DATE: MAY 11, 2018
 SHEET 3 OF 12

DYKSTRA ASSOCIATES, PC
 11 LAWRENCE ROAD
 NEWTON, N.J. 07860
 (973) 579-2177

PROFESSIONAL ENGINEER &
 PROFESSIONAL PLANNER
 N.J. REG. NO. 11665
 N.J. REG. NO. 10944

AMENDED PRELIMINARY & FINAL SITE PLAN NORTH VILLAGE AT SPARTA
 TAX LOTS 91.01, 91.02, 91.03 & 91.04, BLOCK 16001
 SPARTA TOWNSHIP, SUSSEX COUNTY, N.J.

SITE LAYOUT PLAN